



**MYSON** Canada

---

Radiators • Fan Convectors • Towel Warmers

# PRICE LIST

**June 3, 2019**

34 Meteor Drive, Toronto, Ontario M9W 1A4  
**Phone: 416-675-7651      Fax: 416-675-9804**  
**customerservice@hydronicssystems.ca**

Shipping Hours 8:00am – 5:00pm Monday to Friday

Prices are subject to change without notice.  
All Taxes Extra



## **Table of Contents**

### **Purmo**

<b>Compact &amp; Ramo Panel Baseboard Features</b> .....	1
<b>Compact Ventil Panel Baseboard</b> .....	2
<b>Ramo Ventil Panel Baseboard</b> .....	3
<b>Compact &amp; Ramo Panel Radiator Features</b> .....	4
<b>Compact Ventil Panel Radiators</b> .....	5, 6
<b>Ramo Ventil Panel Radiators</b> .....	7
<b>Radiator Accessories</b> .....	8

### **Fan Convectors**

Kickspace, Recessed Wall & Floor Series .....	9
iVector 2 Pipe & 4 Pipe Heat / Cool Series .....	10
Hi – Line & Lo – Line Heat / Cool Series .....	10

### **Towel Warmers**

Hydronic Towel Warmers .....	11
Electric Towel Warmers .....	12
 Radiators Clearance Items .....	 13



## General Information

### Orders

All orders are subject to acceptance by the General Sales Department, Toronto Ontario. No liability shall be incurred by Hydronic Systems Canada Inc. if manufacture or delivery is prevented or delayed by strikes, fires, delays of carriers or other unavoidable delays or beyond its reasonable control, or by inability to obtain materials. Prices quoted herein supersede all prior price lists and are subject to change without notice. Prices do not include any HST or local taxes that may be payable on the manufacture, sale or delivery of the merchandise covered by this price book. In cases where we are obliged to collect taxes, the same will be billed to the buyer.

### Payment Terms

Any allowable cash discounts will be shown on the face of the invoice. Any cash discounts taken after the allowable date will be disallowed and become due and payable. Where no cash discount is shown, terms are net 30 days from date of invoice. Interest at the rate of 2% per month will be charged on all past due accounts. An order for items included in this price book for which invoice prices aggregate less than \$50.00 net will be billed at \$50.00.

### Freight Terms

Prices quoted herein are F.O.B., our Toronto warehouse. Shipping weights supplied in the price book are approximate, for buyers' convenience only, and are not guaranteed. Please provide your choice of transportation facilities and shipping point. Extra freight and handling charges will apply for non-stock "rush" shipments.

### Delivery

Delivery to the initial carrier shall constitute delivery to the buyer. The seller's responsibility ceases upon delivery in good order to such carrier, and all merchandise is shipped at the buyer's risk. The buyer is urged to examine all deliveries before signing transportation receipts. If merchandise is visibly damaged, the buyer should insist that written confirmation of the damage be noted on the freight bill by the agent of the carrier. If damage is discovered after unpacking, their carrier should be notified at once so that inspection can be made and the claimed damage substantiated by the carrier.

### Return Material Policy ( within 90 days of purchase only )

No material may be returned without prior written authorization from the Company. Material arriving at Hydronic Systems Canada Inc. without prior authorization will be refused. New material of current manufacture normally stocked, in saleable condition, in original sealed carton may be returned within 90 days of purchase, freight prepaid, after written authorization has been received. In such cases credit will be allowed, less 25% or \$50.00 restocking charge, whichever is greater, provided that the equipment is received free of shipping or other damage. Goods not received in the original sealed carton will be refused. Customer will request a "Return Goods Authorization" request form to be completed prior to issuance of a return goods number. A Return Goods Authorization Number may subsequently be issued.

### Warranty Claims

Hydronic Systems Canada Inc. will provide "in-warranty" service consistent with the Manufacturers' warranties F.O.B. its warehouse at 34 Meteor Drive, Toronto, Ontario. All warranty claims will be subject to inspection for defect(s) in material and workmanship. If necessary it may be required to return items to the manufacturer for final determination. In such cases additional time for processing a claim will be incurred. Manufacturers' warranties generally provide for repair or replacement of components found to be defective. Any advance warranty replacement component will require a bon-a-fide purchase order which may be subject to credit pending warranty inspection. If the manufacturer elects to repair a deemed defective item, such item will be returned to the customer and no further allowances will be made.

**All Prices are F.O.B. Toronto, Ontario**  
**Payment Terms 1% - 15 Days Net 30**



**MYSON** Canada

**PURMO**

**Compact & Ramo**

---

## Panel Baseboard

---

### A Better Option than Fin-Tube...

- Panel baseboards provide both convective and radiant heat enhancing total comfort
- Faster heat-up rate with built-in valve for smarter control (heads sold separately)
- Efficient and energy saving for your customers
- Optimal use of low temperature radiators outperforms high temperature fin-tube
- Perfect solution for low temperature systems using condensing boilers, heat pumps and solar systems
- Decorative style with finished top grille and side covers
- Higher BTUH output than fin-tube baseboard
- Outperforms the most powerful heat emitters

#### **COMPACT CV 21S / 22**



#### **RAMO RCV 21S / 22**



#### **Baseboard comes packaged with:**

- RAL9016 white
- adjustable wall brackets
- one (1) air vent
- built-in thermostatic valve (heads sold separately)
- two (2) blind plugs
- side connections
- dual bottom connections

Av = Availability

S = Normally Stocked

1 – 12 = Non-Stock, normal lead time in weeks, not subject to return

---

All Prices are F.O.B. Toronto, Ontario  
Payment Terms 1% - 15 Days Net 30



**MYSON** Canada

**PURMO** Compact Ventil  
Panel Baseboard



### CV21S Single Panel 8" High (200mm)

Av	Model	Length	BTUH Outputs						Ship Wt LBS	Trade Price
			180°F	160°F	140°F	120°F	110°F	100°F		
S	CV21S 200-600	24"	1,346	1,063	781	485	390	283	17	\$ 112.00
S	CV21S 200-900	36"	2,022	1,597	1,173	728	586	425	25	161.00
S	CV21S 200-1200	48"	2,698	2,131	1,565	971	782	567	33	204.00
S	CV21S 200-1600	63"	3,598	2,842	2,087	1,295	1,043	756	43	256.00
S	CV21S 200-1800	71"	4,046	3,196	2,266	1,456	1,092	769	48	279.00
S	CV21S 200-2000	79"	4,496	3,552	2,608	1,619	1,304	944	54	302.00
S	CV21S 200-2600	103"	5,842	4,615	3,388	2,103	1,694	1,227	71	342.00

### CV22 Double Panel 8" High (200mm)

Av	Model	Length	BTUH Outputs						Ship Wt LBS	Trade Price
			180°F	160°F	140°F	120°F	110°F	100°F		
S	CV22 200-600	24"	1,776	1,403	1,030	639	515	373	19	\$ 145.00
S	CV22 200-900	36"	2,668	2,108	1,547	960	774	560	28	209.00
S	CV22 200-1200	48"	3,968	3,135	2,301	1,428	1,151	833	38	256.00
S	CV22 200-1600	63"	4,758	3,759	2,760	1,723	1,380	999	49	298.00
S	CV22 200-2000	79"	5,939	4,692	3,445	2,138	1,722	1,247	62	353.00
S	CV22 200-2600	103"	7,706	6,088	4,469	2,774	2,234	1,618	80	412.00

#### Radiator Prices Include:

- RAL9016 white
- adjustable wall brackets
- one (1) air vent
- built-in thermostatic valve (heads sold separately)
- two (2) blind plugs
- side connections
- dual bottom connections

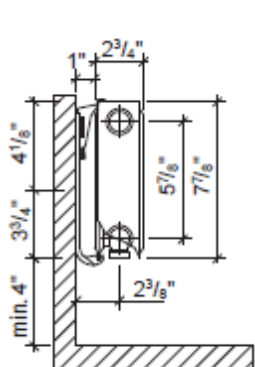

CV21S Baseboard

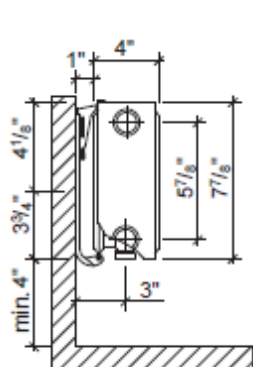

CV22 Baseboard

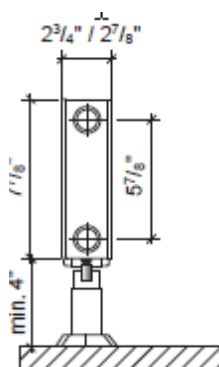

CV21S Pedestal

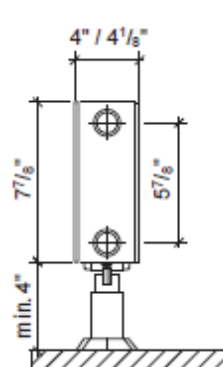

CV22 Pedestal

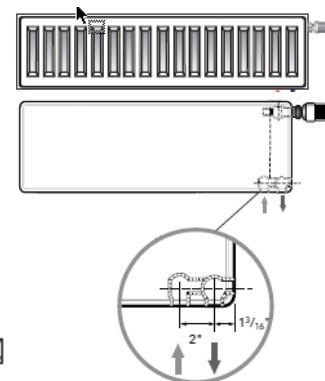

Av = Availability

S = Normally Stocked

1 - 12 = Non-Stock, normal lead time in weeks, not subject to return

All Prices are F.O.B. Toronto, Ontario  
Payment Terms 1% - 15 Days Net 30



### RCV21S Single Panel 8" High (200mm)

Av	Model	Length	BTUH Outputs						Ship Wt LBS	Trade Price
			180°F	160°F	140°F	120°F	110°F	100°F		
S	RCV21S 200-600	24"	1,346	1,063	781	485	390	283	17	\$ 204.00
S	RCV21S 200-900	36"	2,022	1,597	1,173	728	586	425	25	231.00
S	RCV21S 200-1100	44"	2,472	1,953	1,384	890	667	470	30	253.00
S	RCV21S 200-1200	48"	2,698	2,131	1,565	971	782	567	33	276.00
S	RCV21S 200-1600	63"	3,598	2,842	2,087	1,295	1,043	756	43	324.00
S	RCV21S 200-2000	79"	4,496	3,552	2,608	1,619	1,304	944	54	391.00
S	RCV21S 200-2600	103"	5,842	4,615	3,388	2,103	1,694	1,227	71	489.00

### RCV22 Double Panel 8" High (200mm)

Av	Model	Length	BTUH Outputs						Ship Wt LBS	Trade Price
			180°F	160°F	140°F	120°F	110°F	100°F		
S	RCV22 200-600	24"	1,776	1,403	1,030	639	515	373	19	\$ 214.00
S	RCV22 200-900	36"	2,668	2,108	1,547	960	774	560	28	245.00
S	RCV22 200-1200	48"	3,968	3,135	2,301	1,428	1,151	833	38	296.00
S	RCV22 200-1600	63"	4,758	3,759	2,760	1,723	1,380	999	49	347.00
S	RCV22 200-2000	79"	5,939	4,692	3,445	2,138	1,722	1,247	62	424.00
S	RCV22 200-2600	103"	7,706	6,088	4,469	2,774	2,234	1,618	80	544.00

#### Radiator Prices Include:

- RAL9016 white
- adjustable wall brackets
- one (1) air vent
- built-in thermostatic valve (heads sold separately)
- two (2) blind plugs
- side connections
- dual bottom connections

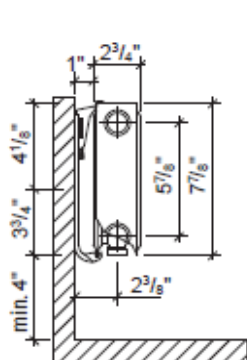

RCV21S Baseboard

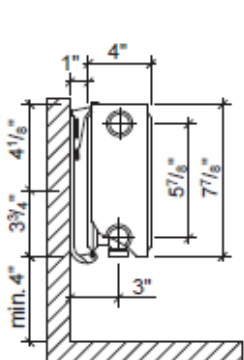

RCV22 Baseboard

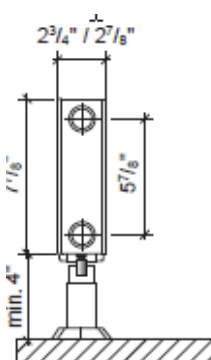

RCV21S Pedestal

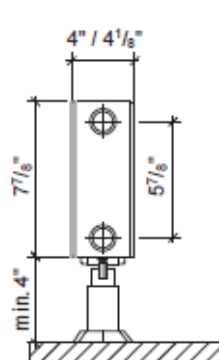

RCV22 Pedestal

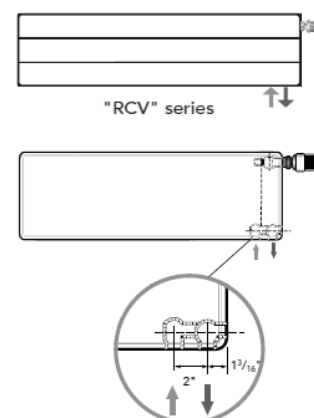

Av = Availability

S = Normally Stocked

1 - 12 = Non-Stock, normal lead time in weeks, not subject to return

All Prices are F.O.B. Toronto, Ontario  
Payment Terms 1% - 15 Days Net 30



**MYSON** Canada

**PURMO**

**Compact & Ramo**

---

## Panel Radiators

---

### Vastly Superior to Fin-Tube Convection...

- Panel radiators provide both convective and radiant heat enhancing total comfort
- Faster heat-up rate with built-in valve for smarter control (heads sold separately)
- Efficient and energy saving for your customers
- Optimal use of low temperature radiators outperforms high temperature fin-tube
- Perfect solution for low temperature systems using condensing boilers, heat pumps and solar systems
- Decorative style with finished top grille and side covers
- Higher BTUH output than fin-tube convectors
- Outperforms the most powerful heat emitters

#### **COMPACT CV 22**



#### **RAMO RCV 22**



#### **Radiator comes packaged with:**

- RAL9016 white
- adjustable wall brackets
- one (1) air vent
- built-in thermostatic valve (heads sold separately)
- two (2) blind plugs
- side connections
- dual bottom connections

Av = Availability

S = Normally Stocked

1 – 12 = Non-Stock, normal lead time in weeks, not subject to return

---

All Prices are F.O.B. Toronto, Ontario  
Payment Terms 1% - 15 Days Net 30





**CV21S Single Panel 24" High (600mm)**

Av	Model	Length	BTUH Outputs						Ship Wt LBS	Trade Price
			180°F	160°F	140°F	120°F	110°F	100°F		
S	CV21S 600-400	16"	1,829	1,408	1,134	658	494	348	29	\$ 180.00
S	CV21S 600-600	24"	2,744	2,113	1,701	988	741	521	42	196.00
S	CV21S 600-800	32"	3,659	2,817	2,269	1,317	988	695	54	224.00
S	CV21S 600-1000	40"	4,573	3,521	2,835	1,646	1,235	869	66	248.00
S	CV21S 600-1200	48"	5,488	4,226	3,403	1,976	1,482	1,043	78	276.00

**Radiator Prices Include:**

- RAL9016 white
- adjustable wall brackets
- one (1) air vent
- built-in thermostatic valve (heads sold separately)
- two (2) blind plugs
- side connections
- dual bottom connections

Av = Availability

S = Normally Stocked

1 – 12 = Non-Stock, normal lead time in weeks, not subject to return

All Prices are F.O.B. Toronto, Ontario  
Payment Terms 1% - 15 Days Net 30



**CV 22 Double Panel 16" High (400mm)**

Av	Model	Length	BTUH Outputs						Ship Wt LBS	Trade Price
			180°F	160°F	140°F	120°F	110°F	100°F		
S	CV22 400-600	24"	3,363	2,590	1,884	1,211	975	706	29	\$ 269.00
S	CV22 400-800	32"	4,484	3,453	2,511	1,614	1,300	942	39	309.00
S	CV22 400-900	36"	4,995	3,885	2,843	1,798	1,449	1,049	46	328.00
S	CV22 400-1000	40"	5,506	4,317	3,174	1,982	1,597	1,156	48	344.00
S	CV22 400-1200	48"	6,727	5,180	3,767	2,422	1,951	1,413	58	383.00
S	CV22 400-1400	56"	7,848	6,043	4,395	2,825	2,276	1,648	68	423.00
S	CV22 400-1600	63"	8,969	6,906	5,023	3,229	2,422	1,888	77	462.00

**CV 22 Double Panel 24" High (600mm)**

Av	Model	Length	BTUH Outputs						Ship Wt LBS	Trade Price
			180°F	160°F	140°F	120°F	110°F	100°F		
S	CV22 600-400	16"	3,047	2,346	1,706	1,097	823	579	36	\$ 269.00
S	CV22 600-600	24"	4,570	3,519	2,559	1,645	1,325	960	54	286.00
S	CV22 600-800	32"	6,094	4,692	3,412	2,194	1,767	1,280	72	331.00
S	CV22 600-900	36"	6,856	5,279	3,839	2,468	1,988	1,418	81	353.00
S	CV22 600-1000	40"	7,617	5,865	4,265	2,742	2,209	1,560	90	375.00
S	CV22 600-1200	48"	9,140	7,038	5,119	3,290	2,651	1,919	108	419.00
S	CV22 600-1400	56"	10,663	8,211	5,971	3,839	2,879	2,026	126	450.00
S	CV22 600-1600	63"	12,187	9,384	6,825	4,387	3,534	2,259	144	481.00

**Radiator Prices Include:**

- RAL9016 white
- adjustable wall brackets
- one (1) air vent
- built-in thermostatic valve (heads sold separately)
- two (2) blind plugs
- side connections
- dual bottom connections

Av = Availability

S = Normally Stocked

1 – 12 = Non-Stock, normal lead time in weeks, not subject to return

All Prices are F.O.B. Toronto, Ontario  
Payment Terms 1% - 15 Days Net 30



### RCV 22 Double Panel 16" High (400mm)

Av	Model	Length	BTUH Outputs						Ship Wt LBS	Trade Price
			180°F	160°F	140°F	120°F	110°F	100°F		
S	RCV22 400-600	24"	3,363	2,590	1,884	1,211	975	706	36	\$ 331.00
S	RCV22 400-800	32"	4,484	3,453	2,511	1,614	1,300	942	48	371.00
S	RCV22 400-1000	40"	5,506	4,317	3,140	1,982	1,597	1,156	60	410.00
S	RCV22 400-1200	48"	6,727	5,180	3,767	2,422	1,951	1,413	72	462.00
S	RCV22 400-1400	56"	7,848	6,043	4,395	2,825	2,276	1,648	84	529.00
S	RCV22 400-1600	63"	8,969	6,906	5,023	3,229	2,422	1,888	96	595.00

### RCV 22 Double Panel 24" High (600mm)

Av	Model	Length	BTUH Outputs						Ship Wt LBS	Trade Price
			180°F	160°F	140°F	120°F	110°F	100°F		
S	RCV22 600-600	24"	4,570	3,519	2,559	1,645	1,325	960	54	\$ 379.00
S	RCV22 600-800	32"	6,094	4,692	3,412	2,194	1,767	1,280	72	423.00
S	RCV22 600-1000	40"	7,617	5,865	4,265	2,742	2,209	1,560	90	468.00
S	RCV22 600-1200	48"	9,140	7,038	5,119	3,290	2,651	1,919	108	551.00
S	RCV22 600-1400	56"	10,663	8,211	5,971	3,839	2,026	2,879	126	637.00
S	RCV22 600-1600	63"	12,187	9,384	6,825	4,387	3,534	2,259	144	723.00

#### Radiator Prices Include:

- RAL9016 white
- adjustable wall brackets
- one (1) air vent
- built-in thermostatic valve (heads sold separately)
- two (2) blind plugs
- side connections
- dual bottom connections

Av = Availability

S = Normally Stocked

1 – 12 = Non-Stock, normal lead time in weeks, not subject to return

All Prices are F.O.B. Toronto, Ontario  
Payment Terms 1% - 15 Days Net 30



Radiator Valves:

Av	Model	Description	Trade Price
S	2TRV 1/2AN	1/2" Standard Vertical Angle Body	\$ 43.00
S	2TRV 1/2SN	1/2" Standard Straight Body	43.00
S	2TRV 2HD	Standard TRV Head	\$ 48.00
S	LKD 16AN	1/2" Manual Angle Valve	\$ 48.00
S	LKD 16SN	1/2" Manual Straight Valve	48.00

Adapter Fittings:

Av	Model	Description	Trade Price
S	164-68-50	1/2" PEX Adapters (pair)	\$ 29.00
S	101-68-44	1/2" Copper Compression Adapters (pair)	34.00
S	102-82-53	1/2" x 3/4" Male Adapters for PEX and Copper Adapters (pair)	29.00
S	HV - A	Twin Entry By-Pass Valve - Angle	\$ 85.00
S	HV - S	Twin Entry By-Pass Valve - Straight	85.00

Floor Mount:

Av	Model	Description	Trade Price
2	FLRM201	Optional Floor Mount for type 21	\$ 76.00
2	FLRM202	Optional Floor Mount for type 22	80.00

Radiator Brackets:

Av	Model	Description	Trade Price
S	MNCLK200	Wall Bracket 21/22 (1 Pair)	\$ 30.00
S	MNCLK400	Wall Bracket 21/22 (1 Pair)	36.00
S	MNCLK600	Wall Bracket 21/22 (1 Pair)	42.00

Miscellaneous:

Av	Model	Description	Trade Price
S	PC8CH	Chrome Pipe Cover 8" (Qty 1)	\$ 8.00
S	PC8WH	White Pipe Cover 8" (Qty 1)	8.00
S	PC40CH	40" Tall Chrome Pipe Cover (Qty 1)	24.00
S	PC40WH	40" Tall White Pipe Cover (Qty 1)	24.00
S	ESCC	Chrome Pipe Escutcheon (Qty 1)	5.00
S	ESCW	White Pipe Escutcheon (Qty 1)	5.00
S	PR-Cover	Escutcheon Cover (Pair)	17.00
S	S-81-0272	RAL9016 White Touch Up Paint	28.00

Av = Availability

S = Normally Stocked

1 - 12 = Non-Stock, normal lead time in weeks, not subject to return

All Prices are F.O.B. Toronto, Ontario  
Payment Terms 1% - 15 Days Net 30



## Kickspace Heaters – Hydronic

Av	Model	Description	Ship Wt. Lbs.	Trade Price
S	Whispa III 5000	3,589 to 5,443 Btuh with 3' plug-in cord	10	\$ 479.00
S	Whispa III 7000	5,335 to 7,534 Btuh with 3' plug-in cord	12	538.00
S	Whispa III 9000	6,718 to 9,949 Btuh with 3' plug-in cord	14	581.00
S	EZ Hose Kit	30" Hoses with ½" Compression Fittings and Shaft Ball Valves (qty 2)	3	287.00

## Kickspace Heaters – Electric

Av	Model	Description	Ship Wt. Lbs.	Trade Price
S	Whispa E50	Up to 5,460 Btuh, 120V	9	\$ 495.00

## Recessed Wall and Floor Series

Av	Model	Description	Ship Wt. Lbs.	Trade Price
S	Whispa III 5000 WM	3,589 to 5,443 Btuh, Wall Mount	16	\$ 640.00
S	Whispa III 9000 WM	6,718 to 9,949 Btuh, Wall Mount	25	782.00
S	Whispa III 5000 FM	3,589 to 5,443 Btuh, Floor Mount	16	712.00

## RCU "All-One-Unit" Commercial Wall Series

Recessed Wall Unit with 24V Transformer, Solenoid Valve, Flow Control and Purge Valve

Av	Model	Description	Ship Wt. Lbs.	Trade Price
S	Whispa III 5000 RCU	3,589 to 5,443 Btuh, Wall Mount	28	\$ 1,020.00
S	Whispa III 9000 RCU	6,718 to 9,949 Btuh, Wall Mount	35	1,216.00
S	Whispa III 12000 RCU	1,760 to 12,149 Btuh, Wall Mount	48	1,354.00

Av = Availability

S = Normally Stocked

1 – 12 = Non-Stock, normal lead time in weeks, not subject to return

All Prices are F.O.B. Toronto, Ontario  
Payment Terms 1% - 15 Days Net 30



**iVector 2 Pipe** (Height 23 5/8", Depth 6")

Wall Mount Single Circuit Coil for Heating / Cooling with Programmable Controls

Av	Model	Length	Heating Cap. Btuh	Cooling Cap. Btuh	Ship Wt. Lbs.	Trade Price
S	IV60 FX 80 – 2	31-1/2"	8,423 to 14,874	2,412 to 5,623	51	\$ 1,854.00
S	IV60 FX 100 – 2	39-3/8"	11,531 to 20,593	3,450 to 7,861	66	1,990.00
S	IV60 FX 120 – 2	47-1/4"	13,919 to 26,323	5,186 to 9,956	74	2,227.00
S	IV60 FX 140 – 2	55-1/8"	16,364 to 31,755	5,084 to 12,055	84	2,561.00
S	IV60 FX 160 – 2	63"	18,864 to 37,178	5,899 to 14,150	95	2,753.00

**iVector 4 Pipe** (Height 23 5/8", Depth 6")

Wall Mount Dual Circuit Coils for Heating / Cooling with Programmable Controls

Av	Model	Length	Heating Cap. Btuh	Cooling Cap. Btuh	Ship Wt. Lbs.	Trade Price
12	IV60 FXC 80 – 4	31-1/2"	5,961 to 10,613	2,292 to 5,342	56	\$ 2,127.00
12	IV60 FX 100 – 4	39-3/8"	8,116 to 14,557	3,277 to 7,468	71	2,263.00
12	IV60 FX 120 – 4	47-1/4"	9,717 to 18,340	4,927 to 9,458	80	2,564.00
12	IV60 FX 140 – 4	55-1/8"	11,404 to 22,040	4,830 to 11,452	91	2,801.00
12	IV60 FX 160 – 4	63"	13,125 to 26,820	5,604 to 13,442	104	3,120.00

**Wall Mount Designer Series (Heat / Cool)**

With Modulating 3-Speed Blower, Electronic Control Board and Remote Control

Av	Hi – Line HC RC (H 14-1/4", D 6-11/16")	Width	Heating Max Btuh	Cooling Max Btuh	Ship Wt. Lbs.	Trade Price
S	HL HC 7 – 4 RC	21-13/16"	7,851	1,941	31	\$ 1,244.00
S	HL HC 10 – 6 RC	26-7/8"	11,388	4,091	35	1,341.00
S	HL HC 15 – 10 RC	34-15/16"	16,188	5,767	41	1,421.00
S	HL HC 20 – 14 RC	56-1/8"	21,094	6,998	49	1,764.00
Av	Lo – Line HC RC (H 15-1/4", D 5-1/8")	Width	Heating Max Btuh	Cooling Max Btuh	Ship Wt. Lbs.	Trade Price
S	LL HC 9 – 6 RC	24-1/4"	9,994	3,564	35	\$ 1,389.00
S	LL HC 14 – 10 RC	32-1/2"	15,052	5,315	42	1,601.00
S	LL HC 19 – 15 RC	43-5/8"	19,637	6,425	50	1,924.00

Av = Availability

S = Normally Stocked

1 – 12 = Non-Stock, normal lead time in weeks, not subject to return

All Prices are F.O.B. Toronto, Ontario  
Payment Terms 1% - 15 Days Net 30



**Steel Construction** (for closed loop systems only)



**COS Straight Ladder Rail Towel Warmers**

Av	Model	BTUH	Height	Width	Trade Price	
					Chrome	White
S	COS 85	1,302	37"	20"	\$ 1,092.00	N/A
S	COS 86	1,525	37"	24"	1,118.00	\$ 820.00
S	COS 125	1,804	51"	20"	1,166.00	976.00
S	COS 126	2,120	51"	24"	1,269.00	1,009.00

**COC Curved Ladder Rail Towel Warmers**

Av	Model	BTUH	Height	Width	Trade Price	
					Chrome	White
S	COC 85	1,302	37"	20"	\$ 1,170.00	\$ 862.00
S	COC 86	1,525	37"	24"	1,190.00	875.00
S	COC 125	1,804	51"	20"	1,249.00	1,025.00
S	COC 126	2,120	51"	24"	1,285.00	1,042.00

**Recommended Accessories:**

Av	Model	Description	Trade Price
S	STDVKIT	Standard Valve Set (2 Valves) – Angle Chrome Body	\$ 174.00
3	V16ACH	Modern Valve Set (2 Valves) – Angle Chrome	420.00
S	V16AWH	Modern Valve Set (2 Valves) – Angle White	367.00
S	SK16 CH	Sleeve Kit – Chrome	138.00
S	SK16 WH	Sleeve Kit – White	132.00

We recommend a valve set and a sleeve kit with all hydronic towel warmers.

Av = Availability

S = Normally Stocked

1 – 12 = Non-Stock, normal lead time in weeks, not subject to return

All Prices are F.O.B. Toronto, Ontario  
Payment Terms 1% - 15 Days Net 30



### Classic Comfort Towel Warmers

Av	Model	Watts	Height	Width	Finish	Trade Price
S	EECOSH 85 WH	200	39"	21"	White	\$ 1,606.00
S	EECOSH 85 CH	200	39"	21"	Chrome	1,532.00

### Gem Series Towel Warmers

**ON SALE**

Av	Model	Watts	Height	Width	Finish	Trade Price
S	FPRL08 B	150	36"	24"	Bright	\$ 399.00
S	FPRL08 M	150	36"	24"	Matte	399.00
S	WDIA05 B	40	17"	20"	Bright	\$ 416.00
S	WDIA05 M	40	17"	20"	Matte	416.00
S	WDIA08 M	130	30"	20"	Matte	464.00
S	WDIA12 M	195	46"	20"	Matte	610.00
S	WPRL08 B	150	30"	24"	Bright	\$ 358.00
S	WPRL08 M	150	30"	24"	Matte	358.00
S	WPRL10 B	185	37"	24"	Bright	416.00
S	WPRL10 M	185	37"	24"	Matte	416.00
S	WRBY04 B	45	16"	24"	Bright	\$ 555.00
S	WRBY04 M	45	16"	24"	Matte	555.00
S	WRBY10 B	120	46"	24"	Bright	833.00
S	WRBY10 M	120	46"	24"	Matte	833.00

For total selection visit [www.mysoncomfort.com](http://www.mysoncomfort.com)

Av = Availability

S = Normally Stocked

1 – 12 = Non-Stock, normal lead time in weeks, not subject to return

All Prices are F.O.B. Toronto, Ontario  
Payment Terms 1% - 15 Days Net 30





Qty Avail.	Model	BTUH @ 180°F	Height	Width	Special Net Each
4	SX 30 140VN	4,333	12"	56"	\$ 74.00
1	SX 30 160VN	4,976	12"	63"	82.00
2	SX 30 180VN	5,570	12"	71"	91.00
4	SX 40 100VN	3,965	16"	40"	65.00
1	SX 40 120VN	4,758	16"	48"	98.00
1	SX 40 90VN	3,568	16"	37"	60.00
1	SX 70 140VN	8,871	30"	56"	118.00
*Above units include a set of Sigarth EZ Install Brackets*					
4	3H11060-VN	1,558	9"	24"	\$ 133.00
1	3H11220-VN	5,724	9"	87"	190.00
2	4H11060-VN	1,940	12"	24"	146.00
2	6H11060-VN	2,887	17"	24"	188.00

\*All brand new product, in original packaging with full warranty. RAL9016 White finish \*

Av = Availability

S = Normally Stocked

1 - 12 = Non-Stock, normal lead time in weeks, not subject to return

All Prices are F.O.B. Toronto, Ontario  
Payment Terms 1% - 15 Days Net 30







**MYSON** Canada

34 Meteor Drive, Toronto, Ontario M9W 1A4  
**Phone: 416-675-7651 Fax: 416-675-9804**  
**[customerservice@hydronicsystems.ca](mailto:customerservice@hydronicsystems.ca)**